

EMT Connector Compression Type

Zinc Die Cast

ELECMAN® Zinc EMT coupling compression type is an electrical fitting designed to join two lengths of Electrical Metallic Tubing (EMT) conduit together in a straight run, using a compression mechanism.

Type:

Compression type

Material:

Zinc die cast

Surface Finish:

Polishing

Certification & Standard

Manufactured to Underwriters Laboratory
Safety Standards UL 514B
UL File No.: E513114



Dimensions:

The dimensions of zinc EMT couplings compression type are as indicated in Table 1.

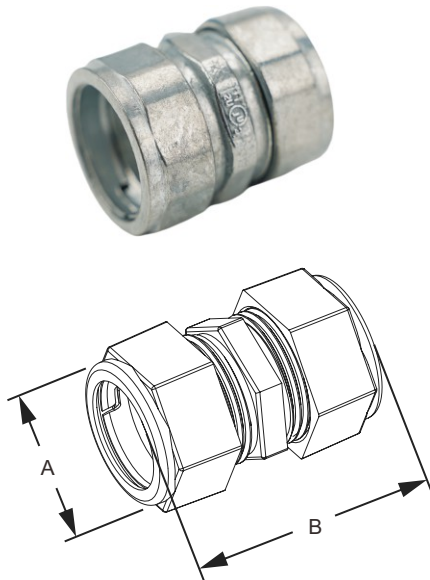

Tabel 1 - Dimensions of zinc EMT couplings compression type

Catalog Number	Trade Size		Dim A	Dim B
	in.	mm	in.	in.
CCP050	1/2"	16	1.100	1.500
CCP075	3/4"	21	1.300	1.610
CCP100	1"	27	1.660	1.850
CCP125	1-1/4"	35	2.090	2.050
CCP150	1-1/2"	41	2.300	2.470
CCP200	2"	53	2.850	2.560
CCP250	2-1/2"	63	2.650	3.280
CCP300	3"	78	4.490	3.420
CCP400	4"	103	5.620	3.530