

One Piece Universal Strut Clamp

Steel

ELECMAN® EMT/Rigid One-Piece Strut Clamp is a specialized fastener designed to secure Electrical Metallic Tubing (EMT) or Rigid Metal Conduit (RMC) to strut channels (metal framing systems used in construction and electrical installations). These clamps are a single, rigid unit, making them quick to install and ideal for applications requiring durability and stability.

Type:

One piece

Material:

Steel

Surface Finish:

Zinc plated

Certification & Standard

Manufactured to Underwriters Laboratory
Safety Standards UL 514B
UL File No.: E541187



Dimensions:

The dimensions of one piece universal strut clamps are as indicated in Table 1.

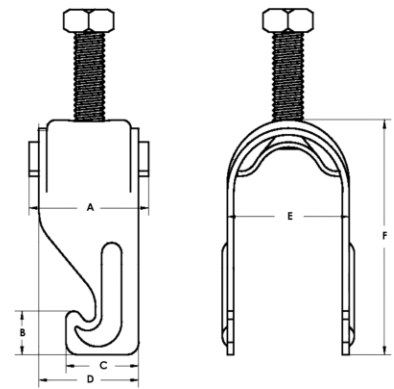

Table 1 - Dimensions of One piece Universal Strut Clamp

Catalog Number	Trade Size	Trade Size	Dim A	Dim B	Dim C	Dim D	Dim E	Dim F
	in.	in.	in.	in.	in.	in.	in.	in.
OSCP050	1/2"	1/2"	1.181	0.413	0.720	0.984	25.400	2.008
OSCP075	3/4"	3/4"	1.181	0.413	0.720	0.984	30.500	2.224
OSCP100	1"	1"	1.181	0.413	0.720	0.984	38.000	2.520
OSCP125	1-1/4"	1-1/4"	1.181	0.413	0.720	0.984	46.000	2.835
OSCP150	1-1/2"	1-1/2"	1.181	0.413	0.720	0.984	49.800	3.110
OSCP200	2"	2"	1.181	0.413	0.720	0.984	64.800	3.740
OSCP250	2-1/2"	2-1/2"	1.181	0.413	0.720	0.984	78.600	4.272
OSCP300	3"	3"	1.181	0.413	0.720	0.984	92.600	4.941
OSCP400	4"	4"	1.181	0.413	0.720	0.984	118.600	5.837